

RoHS
HF

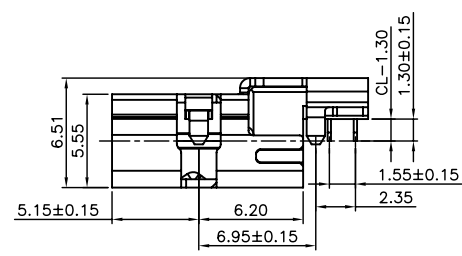

NOTE:
 1. MATERIAL:
 1.1 INSULATOR:HIGH TEMPERATURE PLASTIC UL 94 V-0;BLACK
 1.2 CONTACT:COPPER ALLOY (T=0.20mm)
 1.3 SHELL:SK7 (T=0.50mm)
 2. ELECTRICAL CHARACTERISTICS:
 2.1 CONTACT RESISTANCE:30mΩ Max
 2.2 CONTACT CURRENT RATING:0.5A 40 V
 2.3 DIELECTRIC WITHSTANDING VOLTAGE: 500 V AC FOR 1 MINUTE
 2.4 INSULATION RESISTANCE 100 MΩ Min 500 V DC.
 2.5 OPERATING TEMPERATURE:-40° C ~ 85° C
 3. MECHANICAL CHARACTERISTICS:
 3.1 MATING FORCE:4.5 Kgf Max
 3.2 UNMATED FORCE:1.0~4.0 Kgf AFTER 10000 CYCLES LIFE TEST
 4. PLATING
 4.1 TERMINAL CONTACT: (SEE TAB) GOLD PLATING ALL OVER 50u" MIN NICKEL AND 80u" MIN Tin ALL OVER 50u" MIN NICKEL ON SOLDER AREA
 4.2 SHELL:50u" MIN. NICEL ALL OVER
 5. FOR REFLOW SOLDERING LEAD-FREE PROCESS
 6. PART NUMBER:

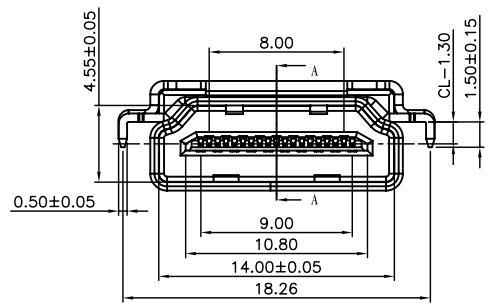
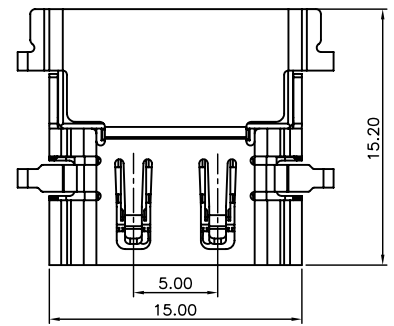
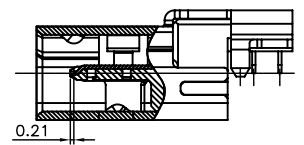
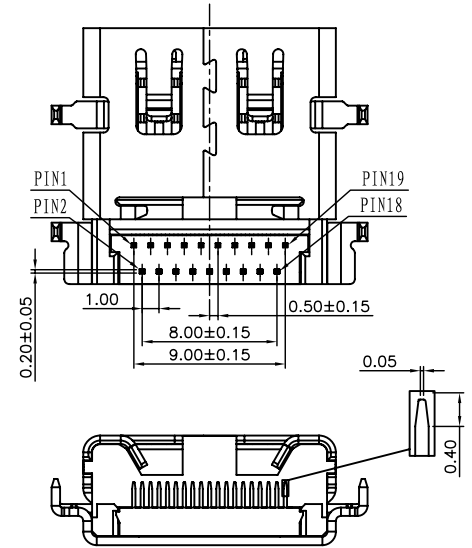
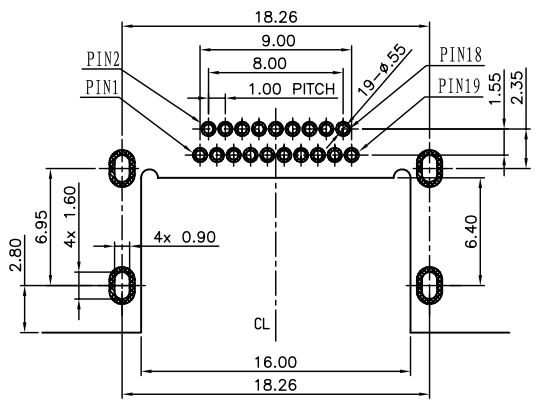
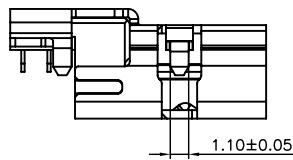

SECTION A-A

TOLERANCE: ±0.05, THICKNESS: 1.2mm
 RECOMMENDED PCB LAYOUT
 (TOP VIEW)
 KEEP OUT AREA

PIN #	SIGNAL ASSIGNMENT	PIN #	SIGNAL ASSIGNMENT	MATING SEQUENCE
1	TMDS Data2+	2	TMDS Data2 Shield	THIRD PIN18 (+5V POWER)
3	TMDS Data2-	4	TMDS Data1+	
5	TMDS Data1 Shield	6	TMDS Data-	
7	TMDS Data0+	8	TMDS Data0 Shield	
9	TMDS Data0-	10	TMDS Clock+	SECOND PIN 1-17 PIN 19
11	TMDS Clock Shield	12	TMDS Clock-	
13	CEC	14	Utility	
15	SCL	16	SDA	
17	DDC/CEC Ground	18	+5V Power	
19	Hot Plug Detect			
SHELL SHIELD				FIRST MAKE

		GENERAL TOLERANCES		SCALE: 1:1	NAME	DATE
		LINEAR	ANGLES	APPROVED	SAM	02/14/2017
A	INITIAL RELEASE	02/14/2017	UNIT: MM	DESIGNER	SAM	02/14/2017
REV.	REVISION RECORD	DATE	SIZE: A4	DRAWN	zhilwu	02/14/2017
			0.00 ±0.20			
			0.00 ±0.10			

WJCT
苏州伟聚电子科技有限公司

PART NO: W-HD01219-0A00
DWG NO: W-HD01219-0A00
REV: A SHEET: 1/2

TITLE: HDMI AF RVS CL 1.30mm H2.43 L15.20mm DIP CONN.

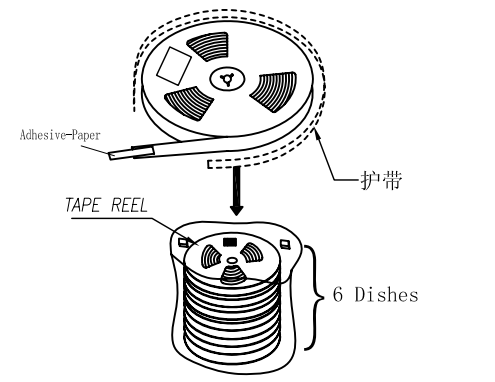
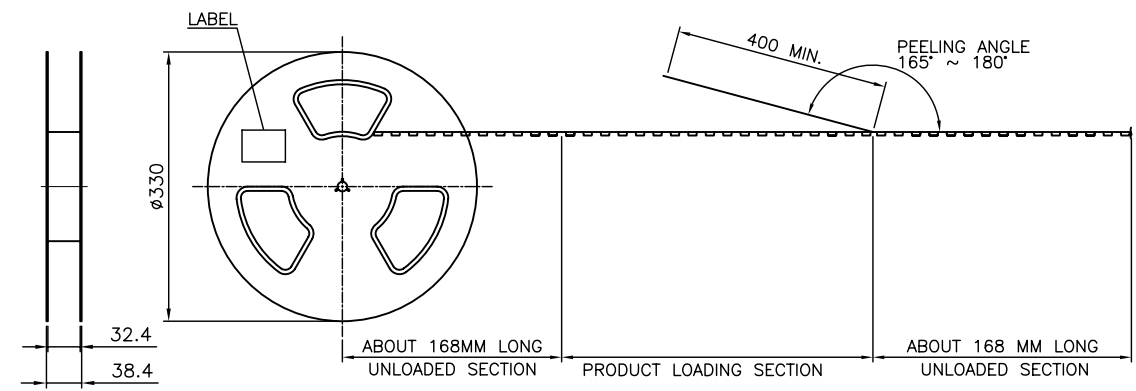

USER DIRECTION OF UNREELING →

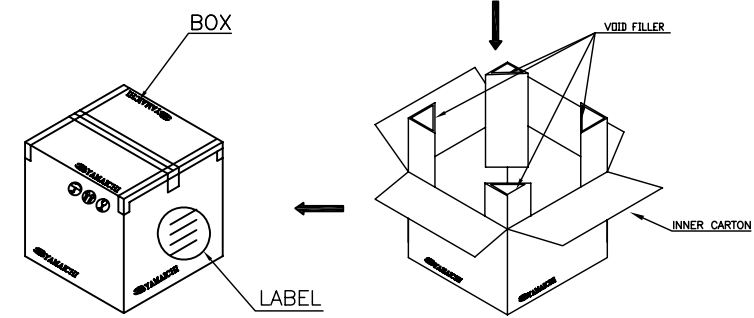
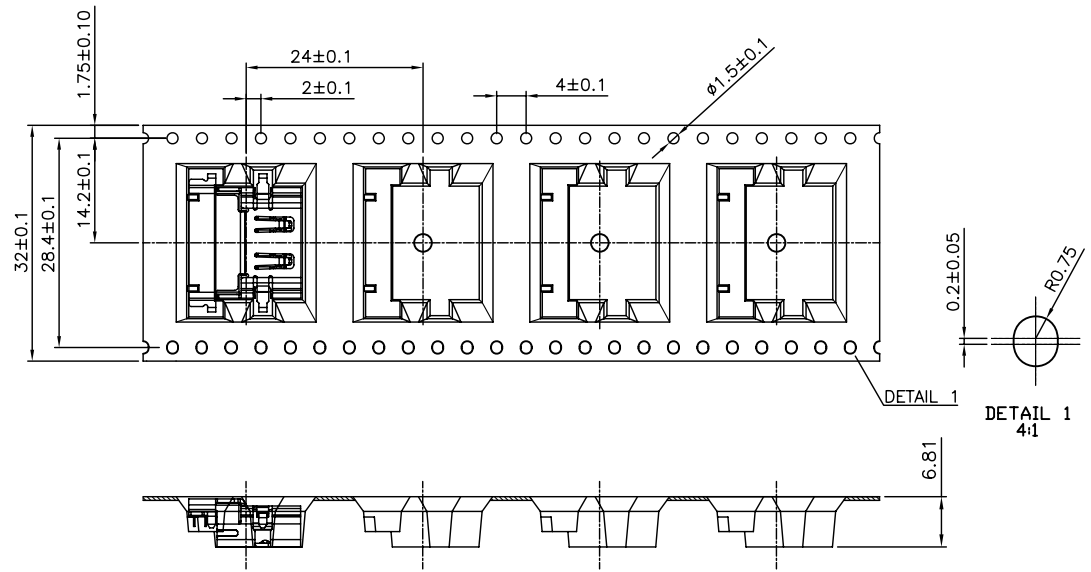

NOTE:

- MATERIAL:
 BOX: FIBREBOARD, CORRUGATED, DOUBLE WALL.
 TAPE: POLYSTYRENES, HEAT-RESISTANT TEMPERATURE: 120°C, BLACK COLOR.
 REEL: POLYSTYRENES, HEAT-RESISTANT TEMPERATURE: 70°C, BLUE COLOR.
 BAG: POLYETHYLENE, HEAT-RESISTANT TEMPERATURE: 100°C.
- PEELING STRENGTH: 0.1 ~ 1.3 N (10 ~ 130 GRAMS)
- PEELING SPEED: 300 mm/min.
- EACH BAG SHALL BE INCLUDED DESICCANT.

350	6	2100 PCS	-- KG	-- KG
PCS/ REEL	REELS/ CARTON	QUANTITY	GROSS WEIGHT	WEIGHT

		GENERAL TOLERANCES		SCALE: 1:1	NAME	DATE
		LINEAR	ANGLES	APPROVED	SAM	02/14/2017
		0.0 ±0.38	X°REF ± 6°	DESIGNER	SAM	02/14/2017
A	INITIAL RELEASE	02/06/2017	UNIT: MM	0.00 ±0.20	X° ± 3°	DRAWN
REV.	REVISION RECORD	DATE	SIZE: A4	0.000±0.10	X°X' ± 2'	zhwu
						02/14/2017

WJCT

苏州伟聚电子科技有限公司

TITLE: HDMI AF RVS CL 1.30mm
H2.43 L15.20mm DIP CONN.

PART.NO: W-HD01219-0A00	
DWG.NO: W-HD01219-0A00	
REV: A	SHEET: 2/2