

CUSTOMER DRAWING

PIN #	SIGNAL ASSIGNMENT	PIN #	SIGNAL ASSIGNMENT	MATING SEQUENCE
1	TMDS Data2+	2	TMDS Data2 Shield	THIRD PIN18 (+5V POWER)
3	TMDS Data2-	4	TMDS Data1+	
5	TMDS Data1 Shield	6	TMDS Data-	
7	TMDS Data0+	8	TMDS Data0 Shield	SECOND PIN 1-17 PIN 19
9	TMDS Data0-	10	TMDS Clock+	
11	TMDS Clock Shield	12	TMDS Clock-	
13	CEC	14	Utility	
15	SCL	16	SDA	
17	DDC/CEC Ground	18	+5V Power	
19	Hot Plug Detect			
SHELL SHIELD				FIRST MAKE

- NOTE:
- MATERIAL:
 - INSULATOR:HIGH TEMPERATURE PLASTIC UL 94 V-0;BLACK
 - CONTACT: COPPER ALLOY(T=0.20mm)
 - SHELL:SK7(T=0.50mm)
 - ELECTRICAL CHARACTERISTICS:
 - CONTACT RESISTANCE:30mΩ Max
 - CONTACT CURRENT RATING:0.5A 40 V
 - DIELECTRIC WITHSTANDING VOLTAGE: 500 V AC FOR 1 MINUTE
 - INSULATION RESISTANCE 100 MΩ Min 500 V DC.
 - OPERATING TEMPERATURE:-40° C ~ 85° C
 - MECHANICAL CHARACTERISTICS:
 - MATING FORCE:4.5 Kgf Max
 - UNMATED FORCE:1.0*4.0 Kgf AFTER 10000 CYCLES LIFE TEST
 - PLATING
 - TERMINAL CONTACT: (SEE TAB) GOLD PLATING ALL OVER 50u" MIN NICKEL AND 80u"MIN Tin ALL OVER 50u" MIN NICKEL ON SOLDER AREA
 - SHELL:50u"MIN. NICKEL ALL OVER
 - FOR REFLOW SOLDERING LEAD-FREE PROCESS

⊗ MARK IS MAJOR DIM.
 PART NO.
 W-HD02719-0A00

HD: HDMI
 19: 19PIN
 0A: G/F
 0: REEL
 0: ROHS+HF

TOLERANCE: ±0.05, THICKNESS: 1.0mm
 RECOMMENDED PCB LAYOUT
 (TOP VIEW)
 ⊗ KEEP OUT AREA

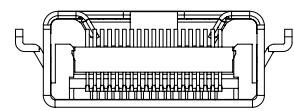
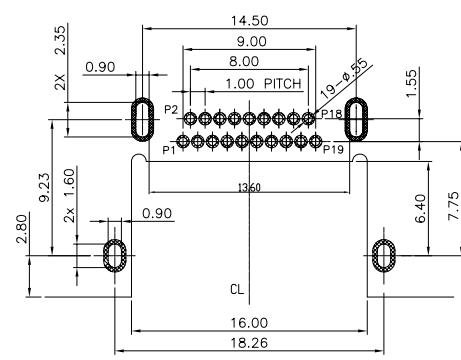
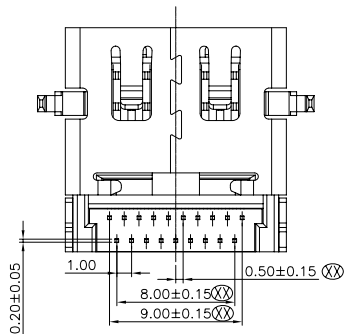
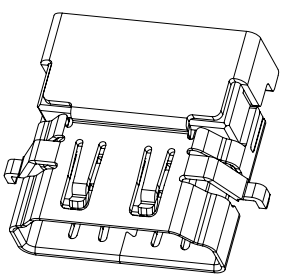
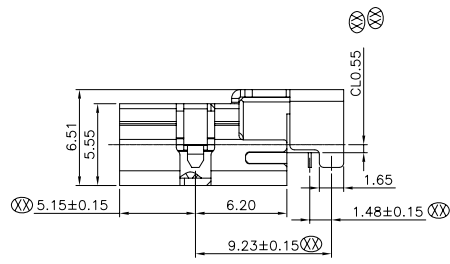
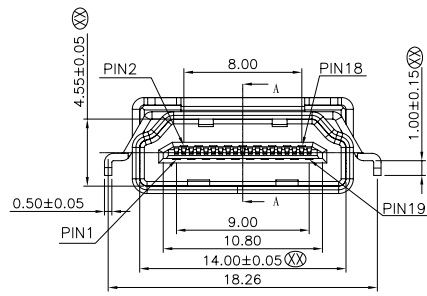
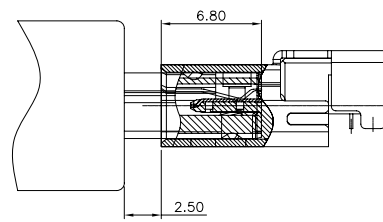
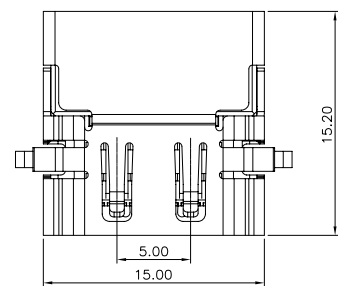

REV.	REVISION RECORD	DATE		GENERAL TOLERANCES		SCALE: 1:1	NAME	DATE	■ 苏州伟聚 □ 东莞胜景 □ 东莞胜蓝 □ 东莞富强	PART.ND:	
X1	DRAFT VERSION	7/10'17		LINEAR	ANGLES	APPROVED				W-HD02719-0A00	
X2	PCB layout 增加标注尺寸	7/16'17	0.0 ±0.30	X'REF ± 6'	DESIGNER	DWG.ND:		W-HD02719-0A00		REV: x2	SHEET: 2/1
			0.00 ±0.20	X' ± 3'	DRAWN	TITLE:		HDMI CL0.55mm H4.28 L15.20mm DIP			
			0.000±0.10	X'X' ± 2'		ZJ	7/16'17				

RoHS
 HF